

Ceiling system – SD35A

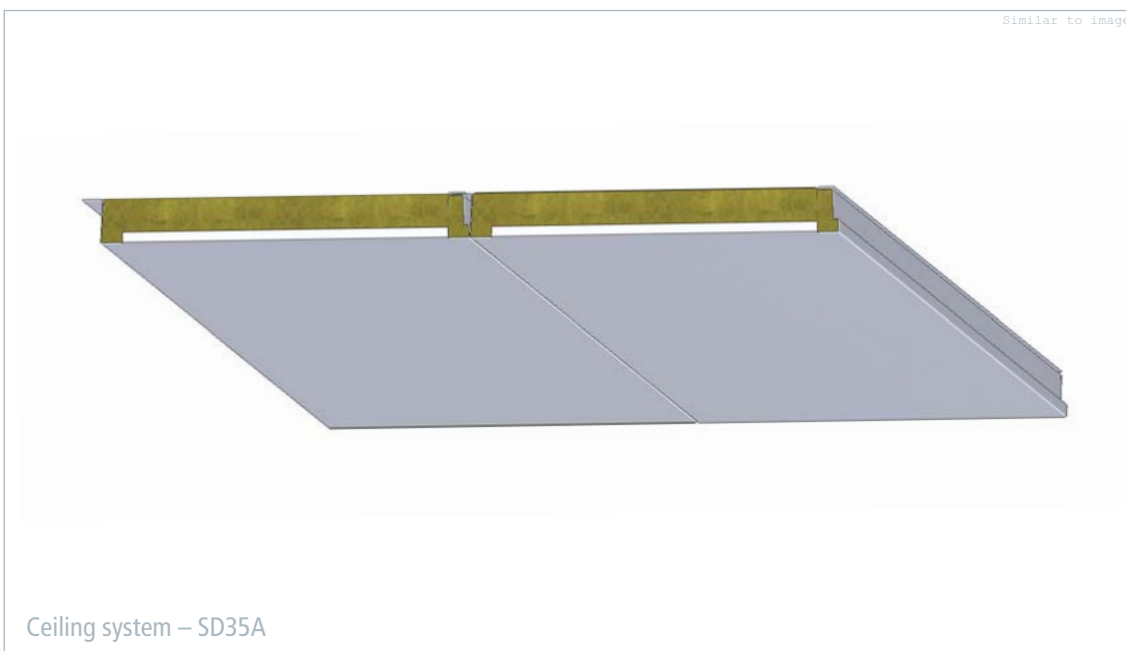
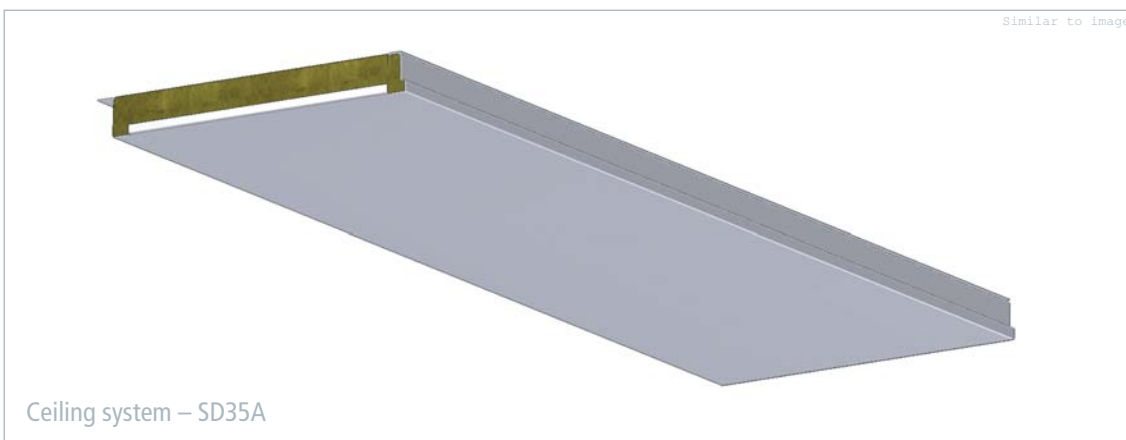

■ The SD35A ceiling system is a sandwich construction made of sheet metal and mineral wool. This design features a high load-bearing capacity. The prefabricated border profiles provide additional strength to the wall system without the need for top profiles. The ceiling can be installed without consideration of the wall height.

After the substructure is mounted, the panels are screwed onto the ceiling using retention hooks. Assembly can be completed from the lower side of a specially designed final panel. With the exception of the two screws needed to attached the final panel, no screwed connections are visible.

A large variety of surface finishes are available; all of them have a removable protective foil to prevent any damage from occurring during installation. The design of the SD35A ceiling system and all components used have been tested and approved according to international standards.

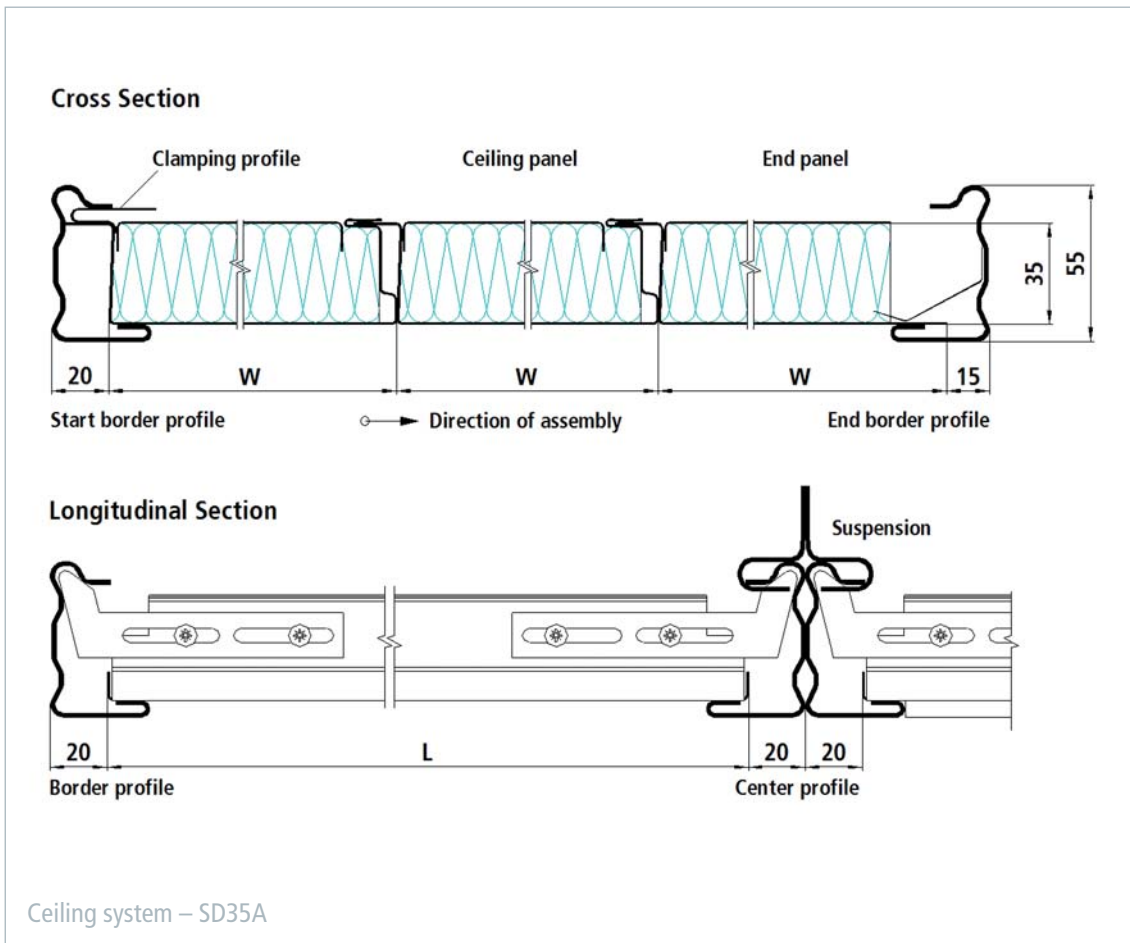

Ceiling system – SD35A	
Technical data	Steel or Stainless steel
Fire classification	B-0
Sound reduction according to DIN EN ISO 140-3	---
Element width	200 – 500 mm
Element length	1000 – 2400 mm
Thickness	35 mm
Mass per area – panel	13.5 kg/m ²
Mass per length – border profiles	1.4 kg/m
Density of insulation material	80 kg/m ³
Coating	PVC foil varnish coated (others on request)
Certification	EC, USCG, RMRS