

Standard corner panels – SW25/SW25NF

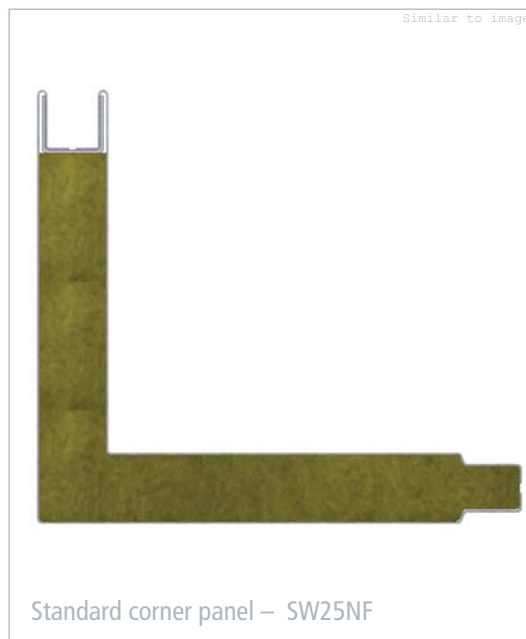

■ The 25 mm-thick corner panels can be fitted into the wall panels SW25 and SW25NF to form a flush connection. This ensures an excellent finish, especially in areas with high aesthetic requirements, as there is no joint where the two panels meet. In addition to the standard dimensions of 150 mm per side and an angle of 90°, other dimensions and angles can be produced on request.

A large variety of surface finishes are available; all of them have a removable protective foil to prevent any damage from occurring during installation. The design of the standard corner panels for the SW25 and SW25NF sandwich and all components used have been tested and approved according to international standards.

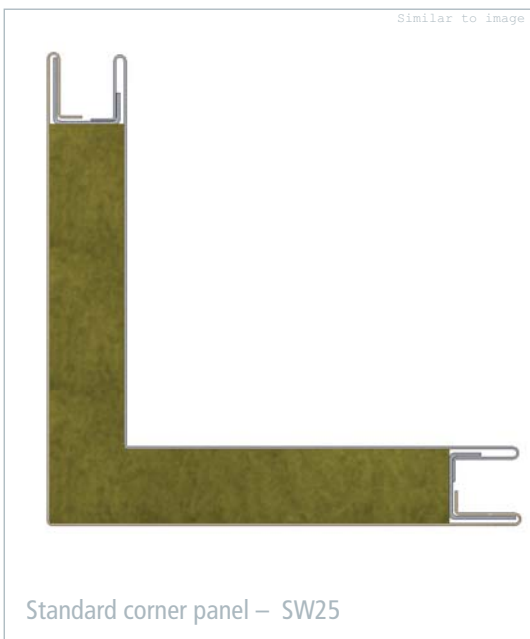
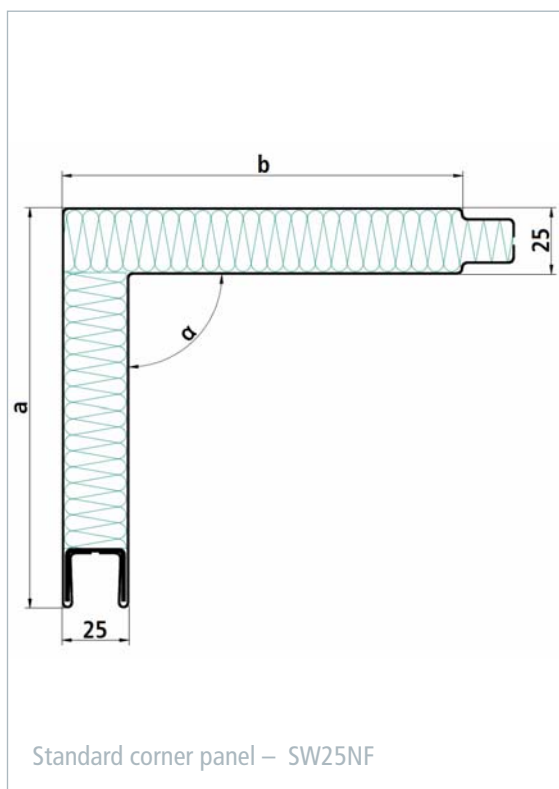
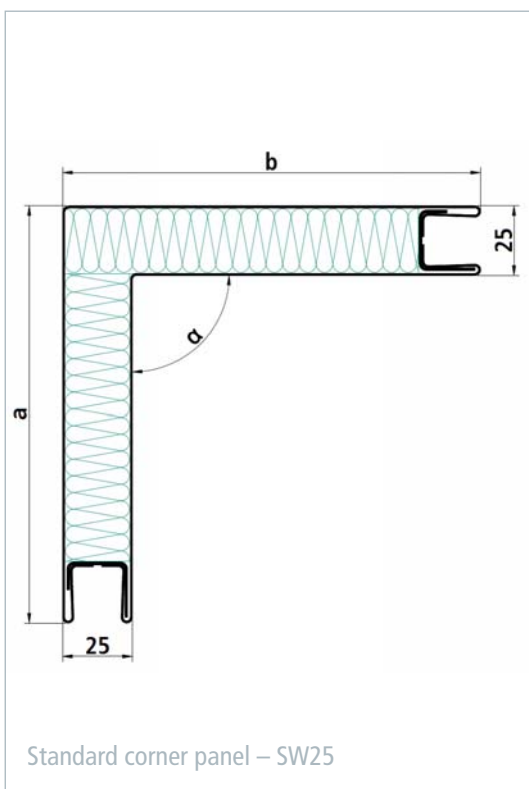

Standard corner panels – SW25/SW25NF		
Technical data	Steel Steel or Stainless steel Stainless steel	Aluminum Aluminum
Fire classification	B-15	C (higher rating in progress)
Element width – side a	150 mm other sizes according to customer specification	150 mm other sizes according to customer specification
Element width – side b	150 mm other sizes according to customer specification	150 mm other sizes according to customer specification
Element length	1000 – 2475 mm	1000 – 2475 mm
Angle between sides	90° other angles according to customer specification	90° other angles according to customer specification
Thickness	25 mm	25 mm
Density of insulation material	150 kg/m ³	150 kg/m ³
Coating	PVC foil varnish coated (others on request)	PVC foil varnish coated (others on request)
Certification	EC, USCG, ABS, RMRS	n/a