

Bulkhead A-60 – M1000

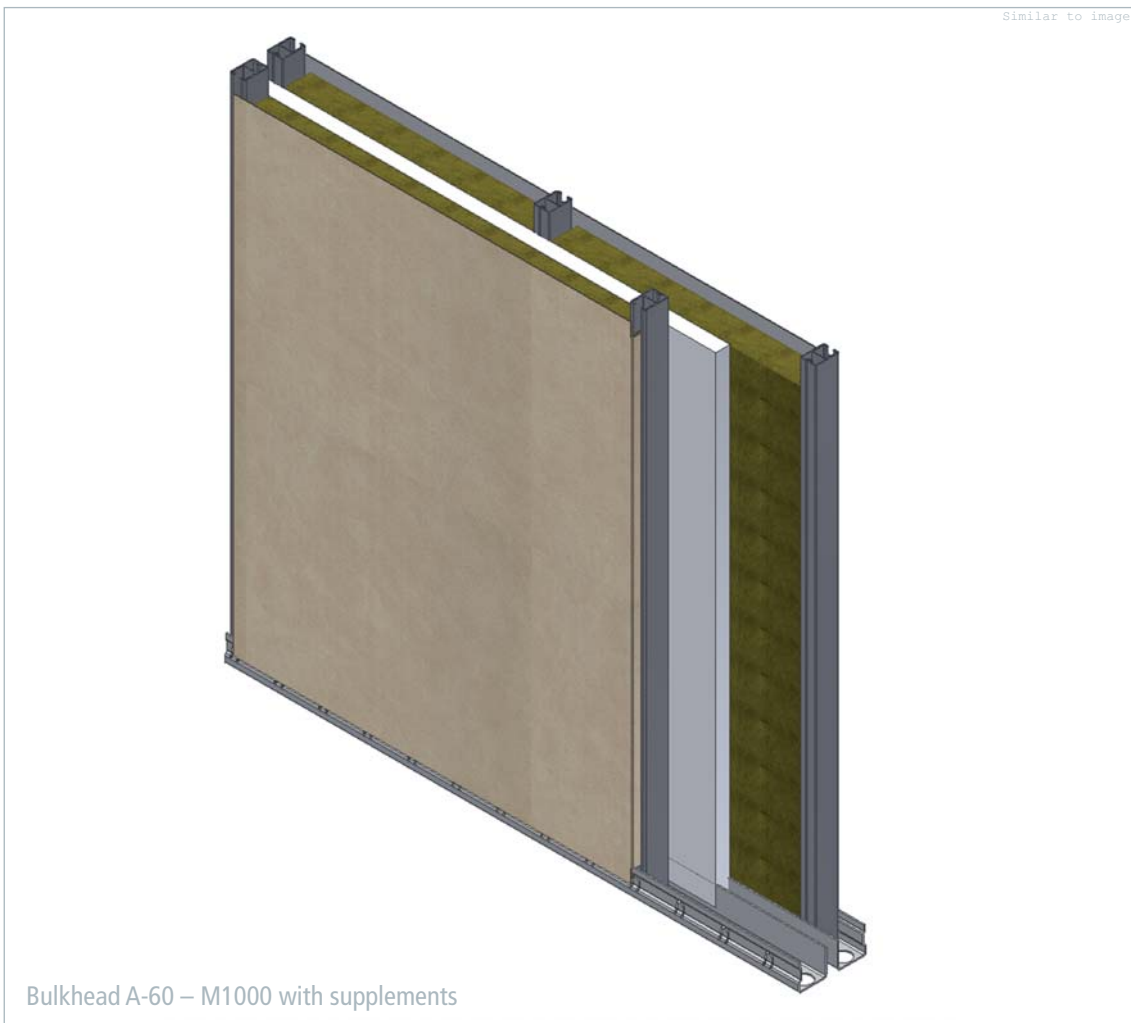

■ The M1000 bulkhead is a construction for high demands on the passive fire protection on board ships. It replaces heavy non-bearing steel bulkheads with conservative insulations. Moreover, it realizes a reduction in mass, because the weight per unit area of this wall is much lower than the traditional steel work. An additional lining is not necessary, because both sides of the bulkhead can be covered with a decorative finish.

A large variety of surface finishes are available; all of them have a removable protective foil to prevent any damage from occurring during installation. The design of the M1000 bulkhead and all components used have been tested and approved according to international standards.

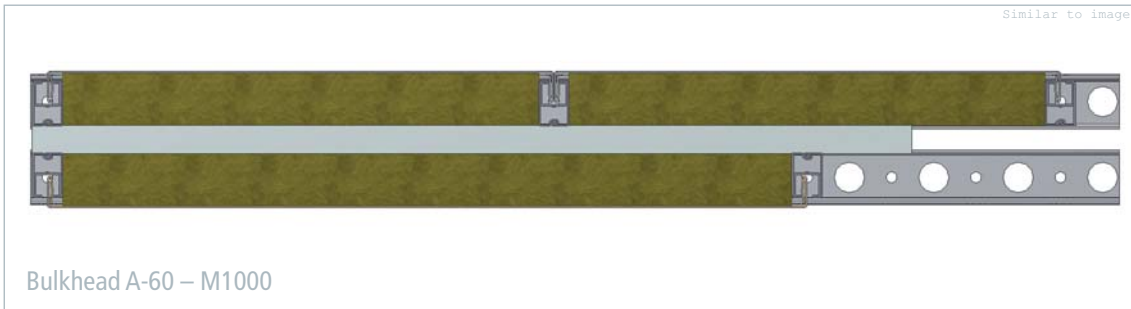
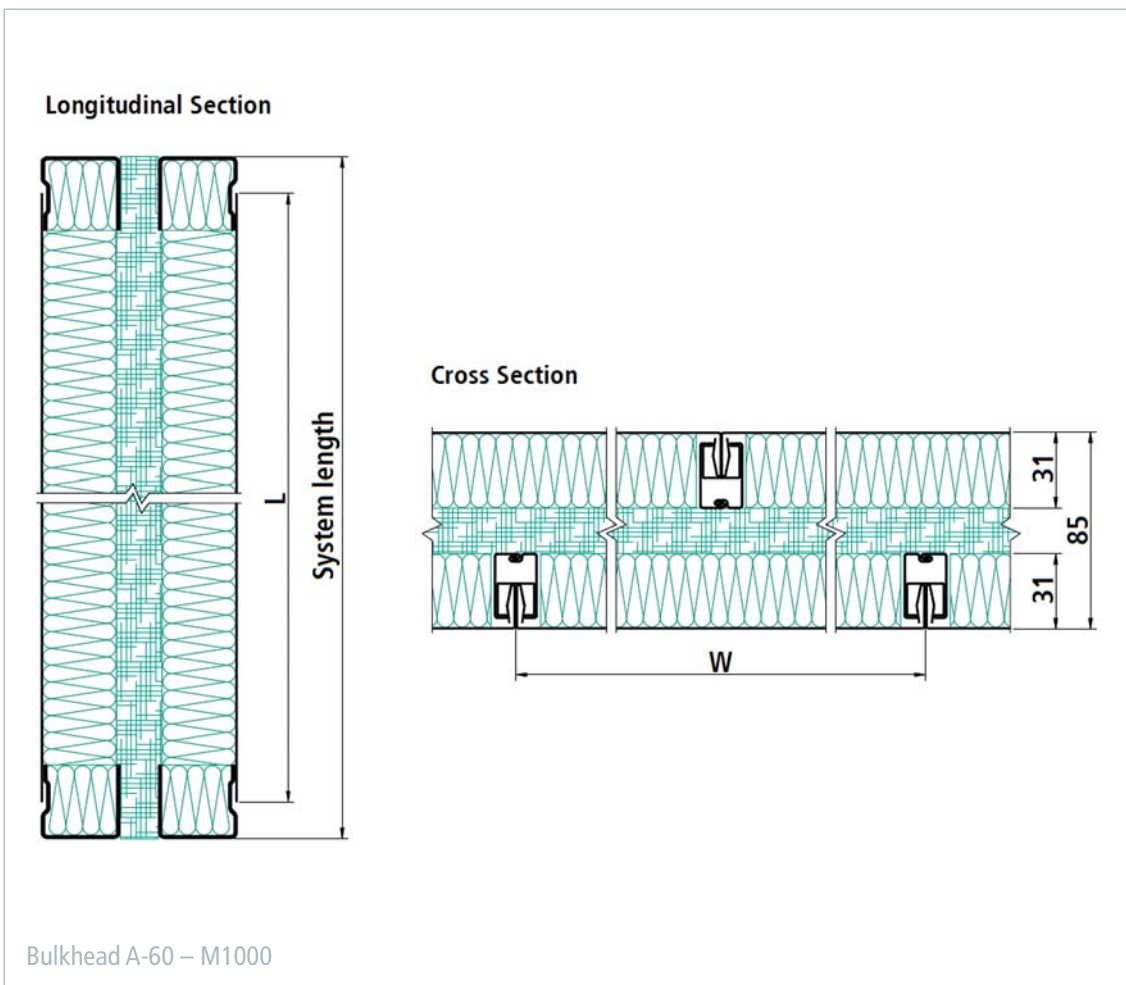

Bulkhead A-60 – M1000	
Technical data	Steel Steel or Stainless steel Stainless steel
Fire classification	A-60
Sound reduction according to DIN EN ISO 140-3	---
Element width	250 – 650 mm
Element length	1000 – 2440 mm
Thickness	85 mm
Mass per area	32.0 kg/m ²
Density of insulation material	128 kg/m ³ / 150 kg/m ³
Coating	PVC foil varnish coated (others on request)
Certification	EC, USCG, ABS