

Hatches for walls and ceilings

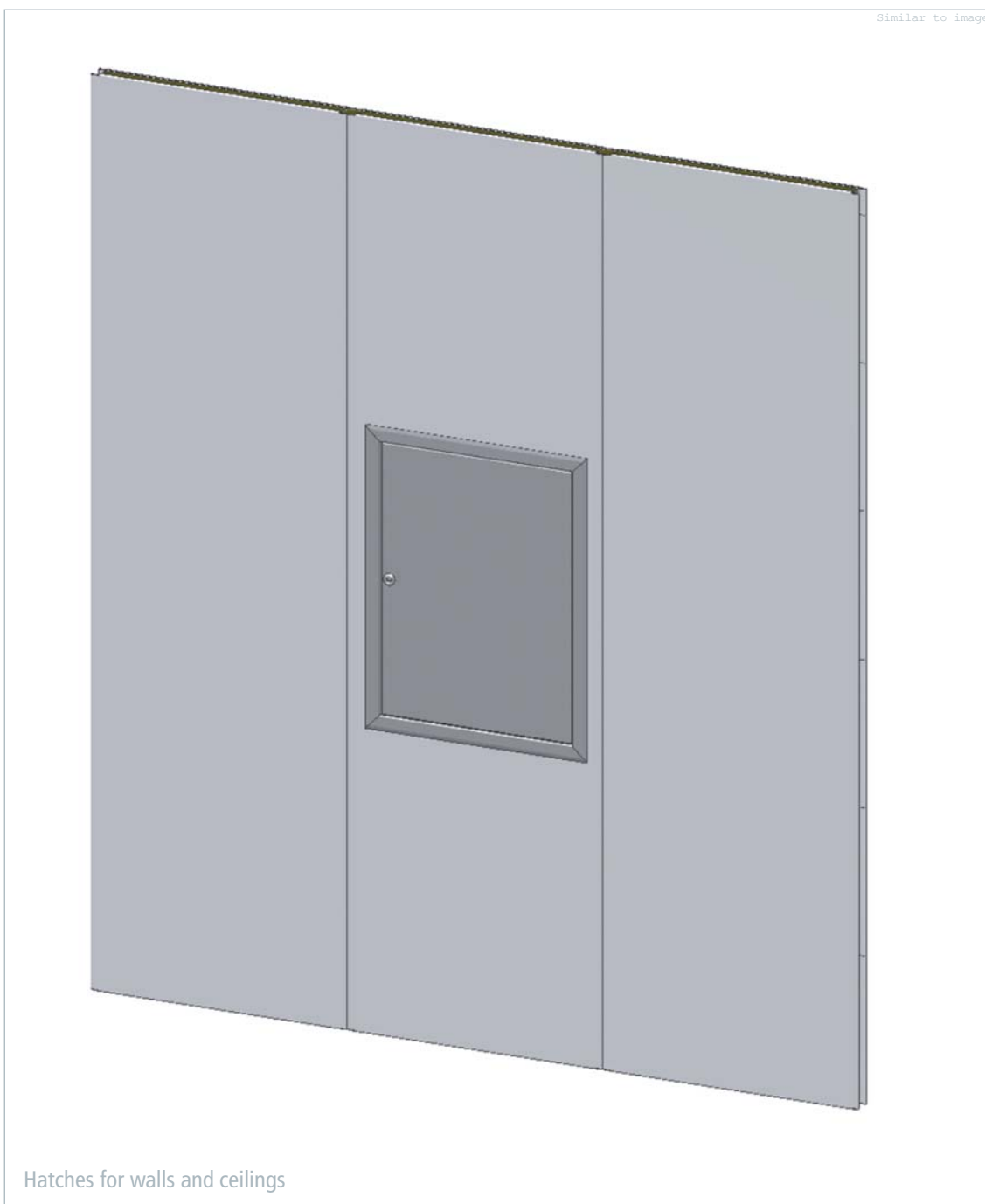

■ The wall and ceiling hatches with fire classification C can be integrated into all wall and ceiling elements where fire protection category A or B is not stipulated, thanks to their simple design. The most diverse dimensions can be produced according to customer specifications. Depending on the length, one or two entering catches are fitted to close the hatch. For mechanical connection to the adjacent panels, the hatches come with a frame which also enhances the system's appearance. A large variety of surface finishes are available; all of them have a removable protective foil to prevent any damage from occurring during installation. All components of the hatches for walls and ceilings have been tested and approved according to international standards.

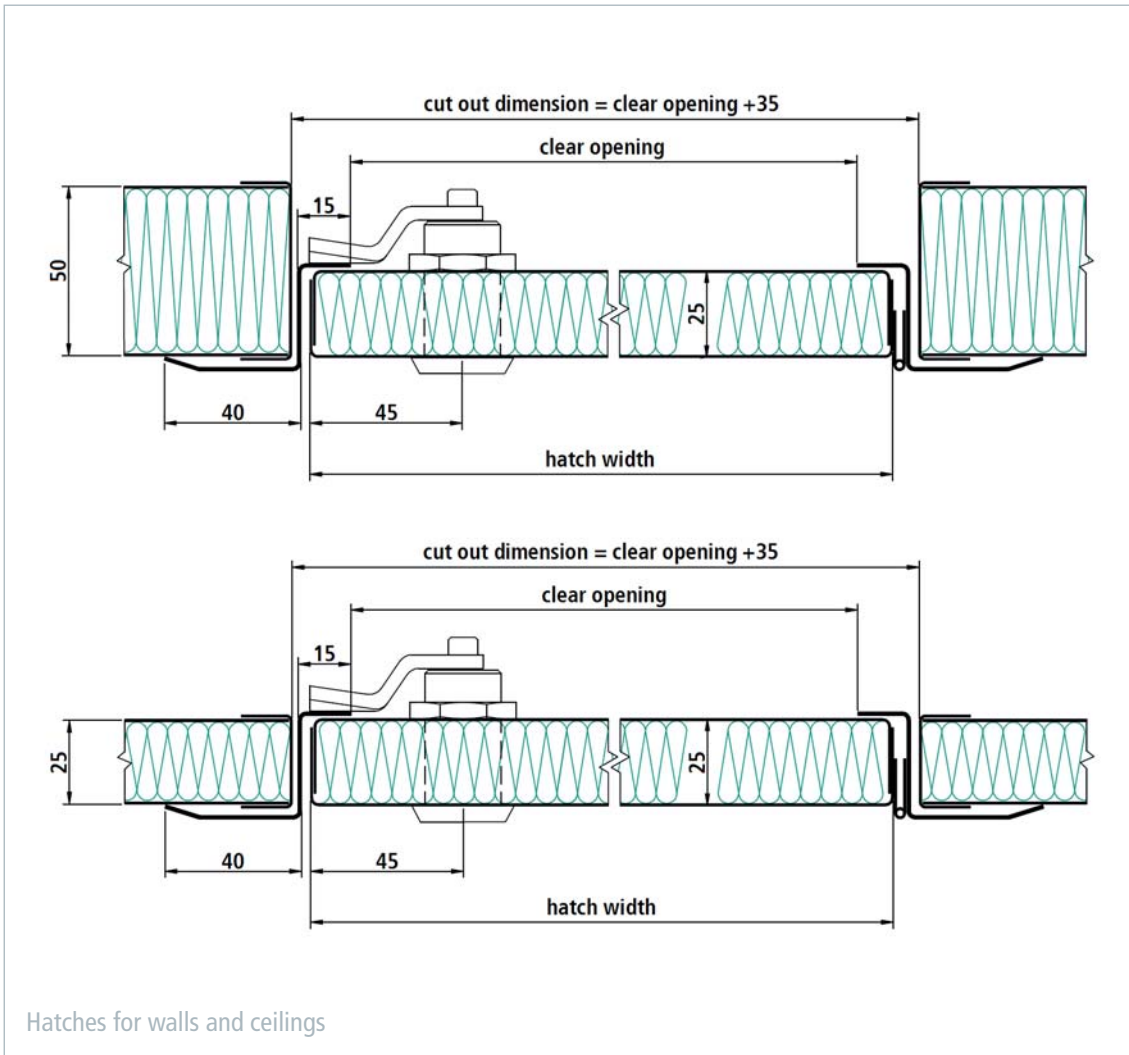

Others

Hatches for walls and ceilings	
Technical data	Steel Steel
Fire classification	C (higher rating in progress)
Element width	max. 700 mm
Element length	max. 1800 mm
Thickness of hatch leaf	25 mm
Applicable for	C constructions
Mass per area	---
Density of insulation material	150 kg/m ³
Coating	PVC foil varnish coated (others on request)
Certification	n/a